

**E ELEVATION**  
1/2"=1'-0" ~ MASTER BATH 208  
INSIDE OF SHOWER

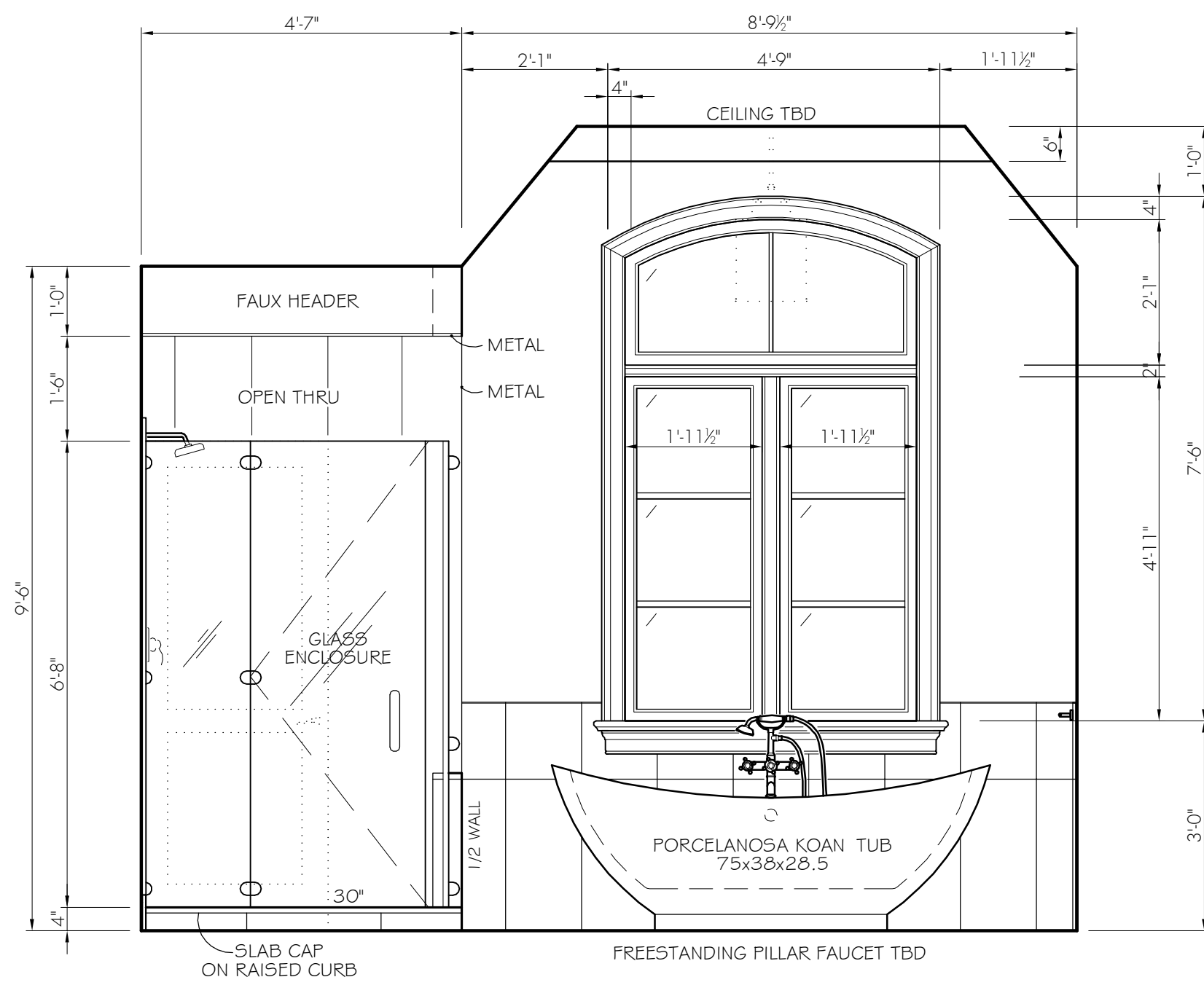

**F ELEVATION**  
1/2"=1'-0" ~ MASTER BATH 208  
OUTSIDE OF SHOWER

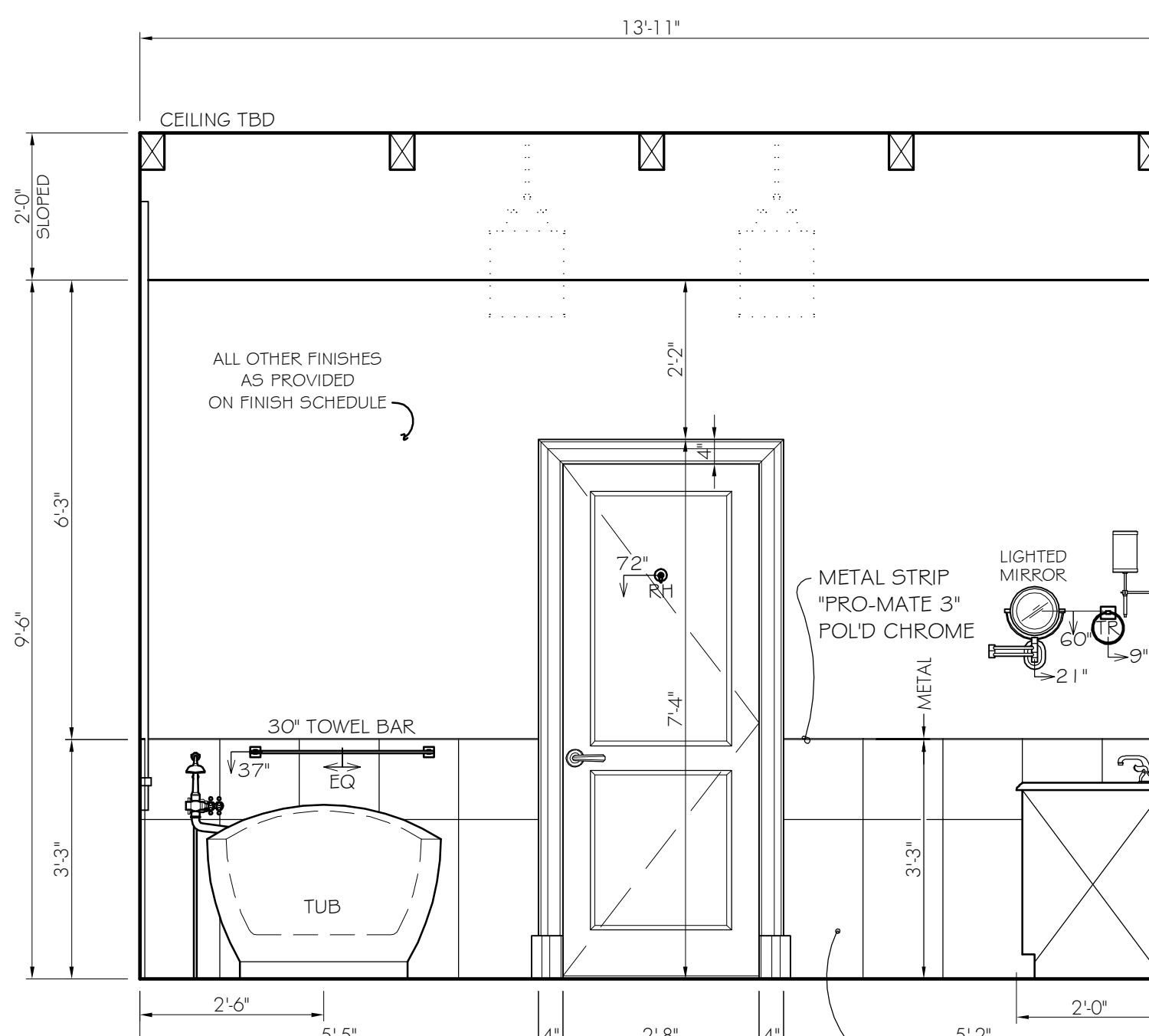

**G ELEVATION**  
1/2"=1'-0" ~ MASTER BATH 208

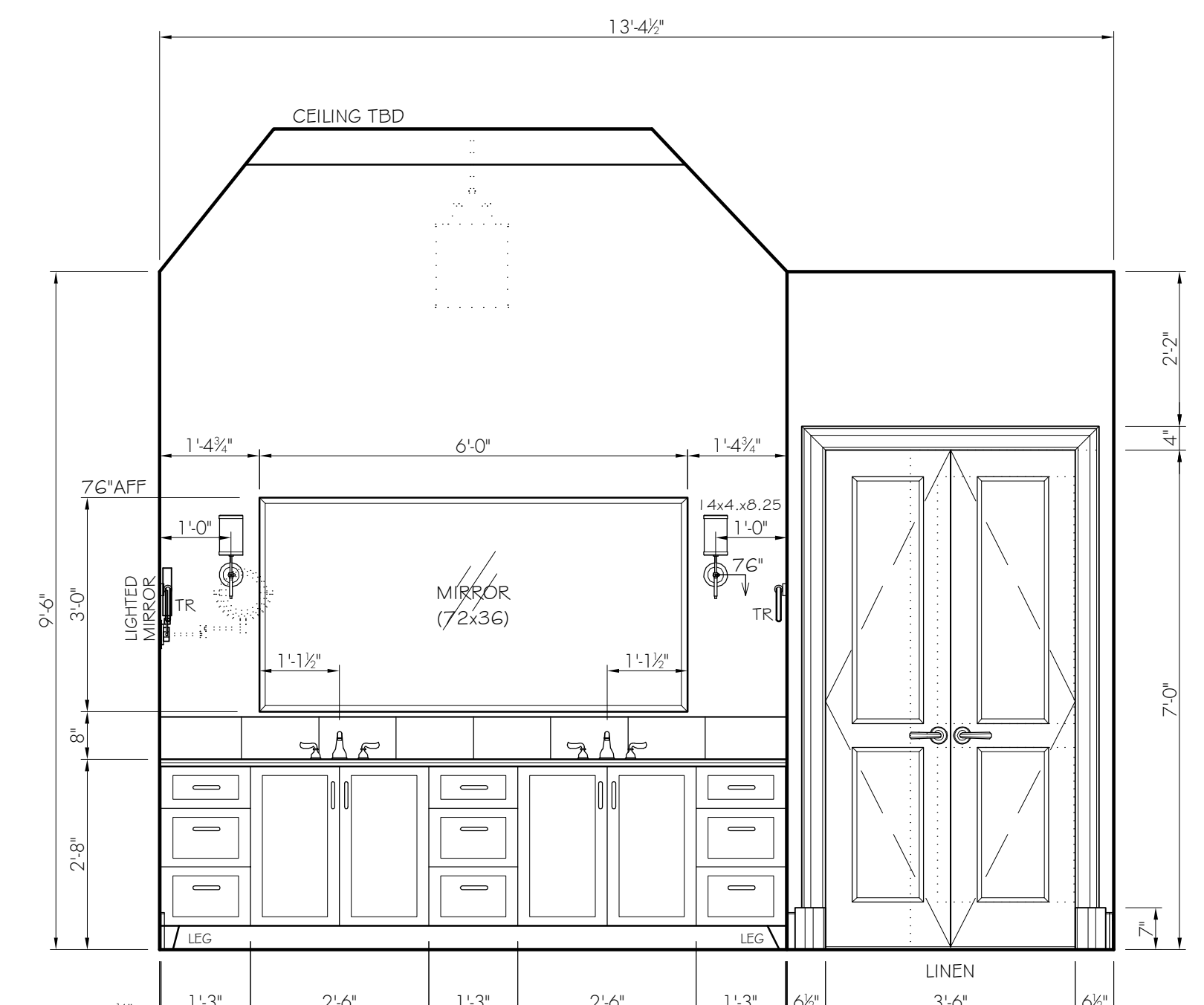

**H ELEVATION**  
1/2"=1'-0" ~ MASTER BATH 208

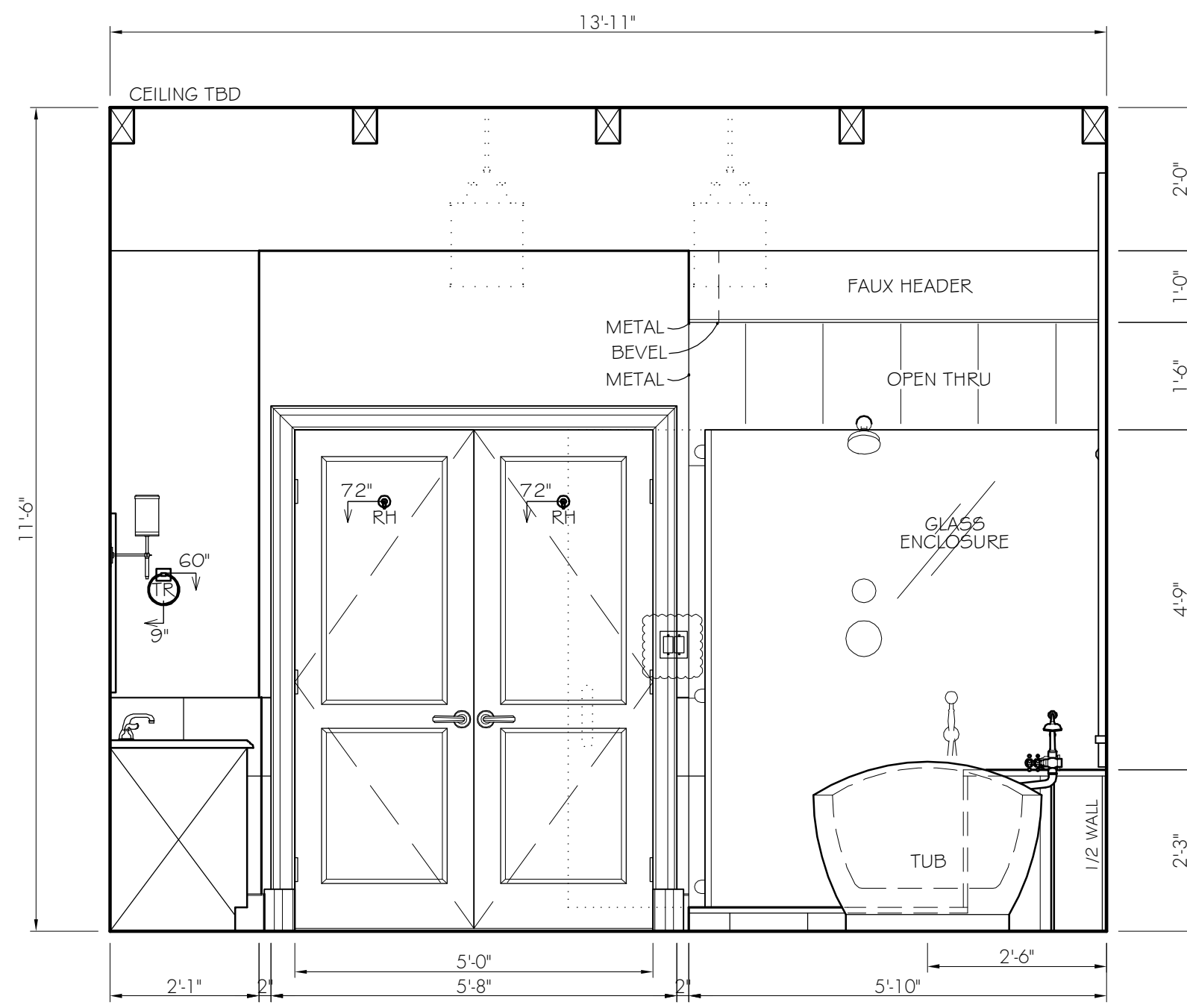

**J ELEVATION**  
1/2"=1'-0" ~ MASTER BATH 208  
OUTSIDE OF SHOWER

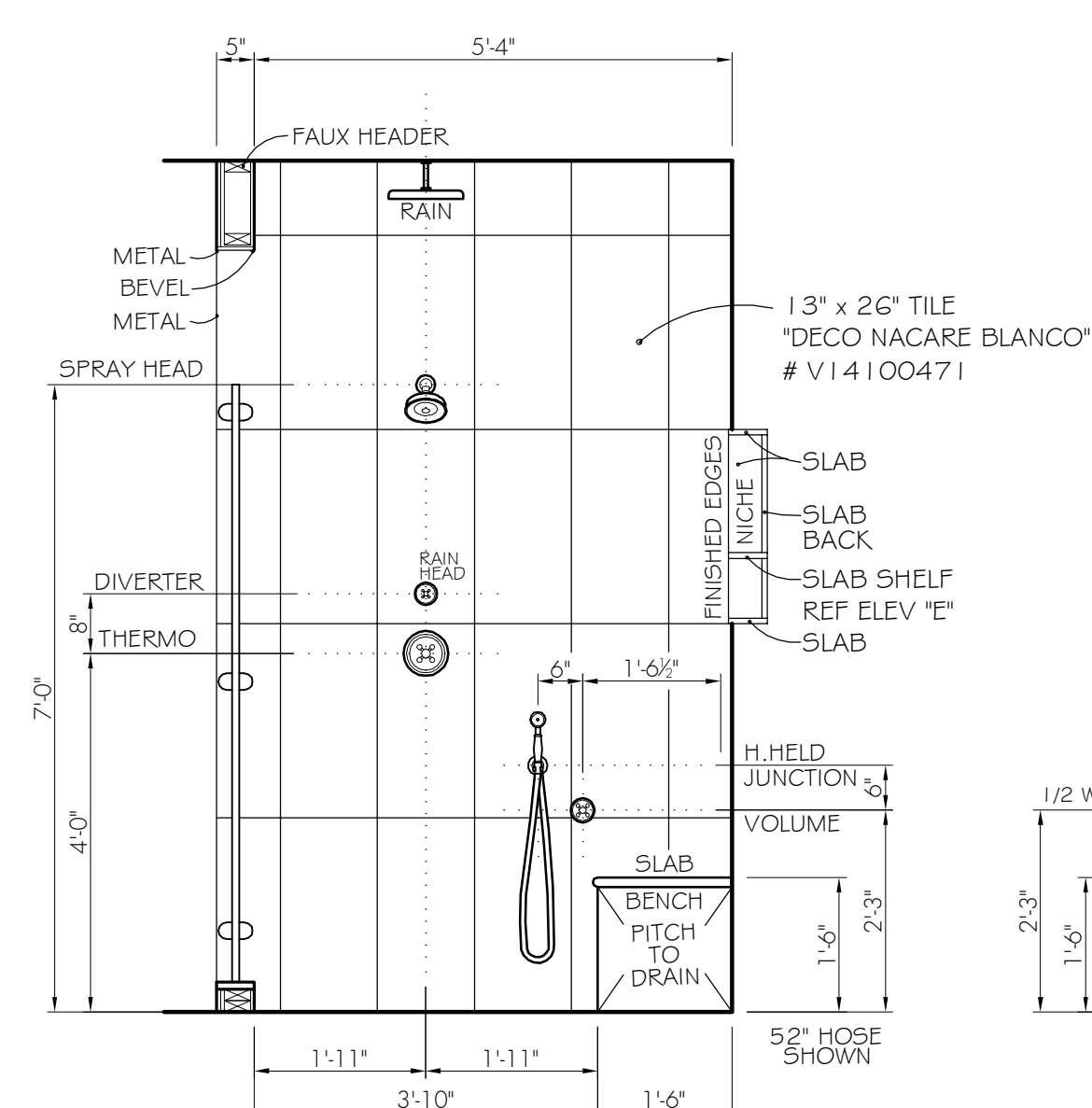

**K ELEVATION**  
1/2"=1'-0" ~ MASTER BATH 208  
INSIDE OF SHOWER

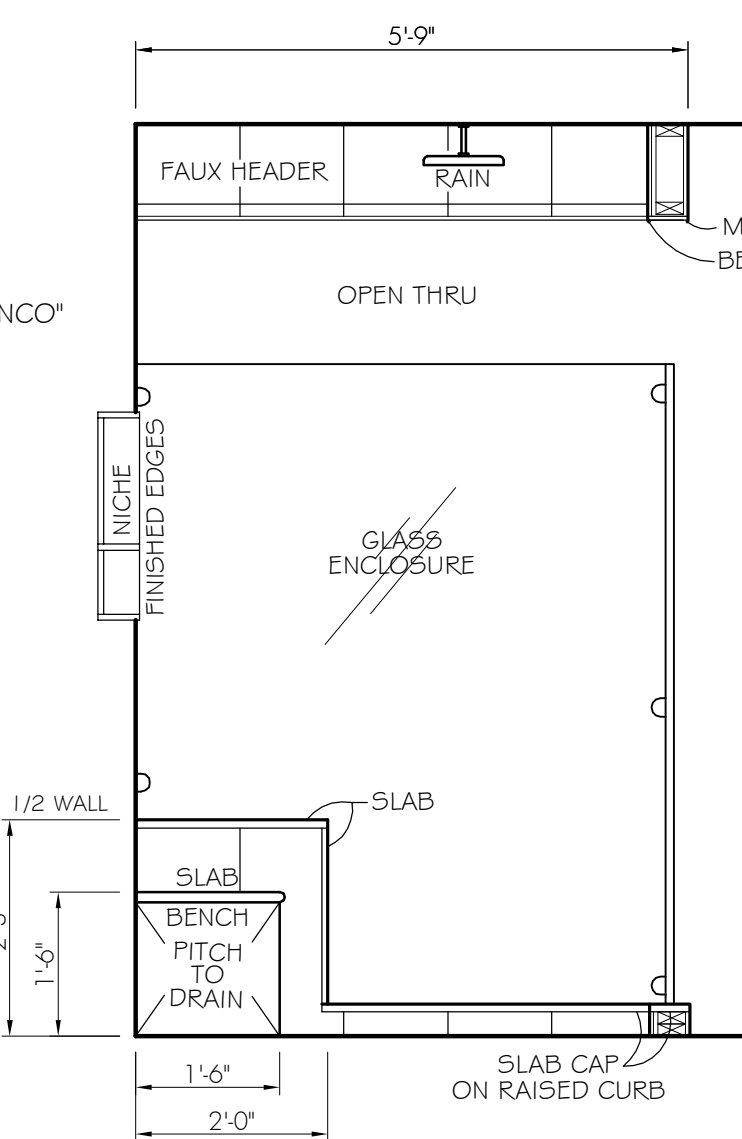

**L ELEVATION**  
1/2"=1'-0" ~ MASTER BATH 208  
INSIDE OF SHOWER

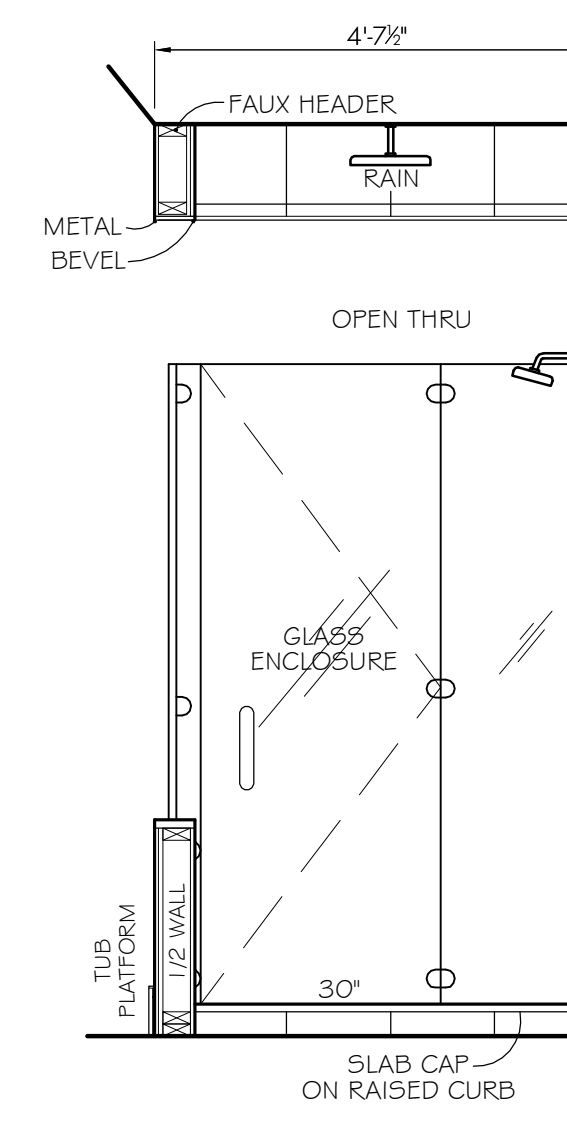

**M ELEVATION**  
1/2"=1'-0" ~ MASTER BATH 208  
INSIDE OF SHOWER

**TILE KEY**

1 2" x 24" TILE ELITE CARRARA # MED-EL30GOCAR	FLOOR
5/8" MOSAIC, 1 2x1 2 SHEETS "WHITE SNOW" POLISHED CUT FOR 6x6 INSERTS	FLOOR INSERTS SHOWER CLG SHOWER FLS
1 3" x 26" TILE "DECO NACARE BLANCO" # V14100471	SHOWER WALLS
METAL STRIP "PRO-MATE 3" POLISHED CHROME # B71133004	FINISHED EDGES
GROUT BUTECH BLANCO-04 UNSANDED	
SLABS # OPAL BLUE QUARTZITE SADDLE # 1-1/4" POLISHED NICHE VANITY: FLAT OGEE EDGE	

HARDWARE FINISH: POLISHED CHROME  
PORCELAIN COLOR: WHITE  
CABINET STYLE: CENTURY, PLAIN INSERT  
CABINETRY FINISH: BIRCH, GLOSS ESPRESSO  
TRIMS FINISH: PAINTED

ESPRESSO from ADELPHI CABINETS

**ROOM LIST**

001 TBD	201 UPPER FOYER
002 TBD	202 UPPER GALLERY
003 TBD	203 HOMEWORK RM
004 TBD	204 LAUNDRY
005 TBD	205 GUEST RM TWO
006 TBD	206 SHARED BATH
007 TBD	207 GABRIELA'S BEDRM
008 TBD	208 MASTER BATH
009 MECHL RM	209 MASTER COMMODOE
010 STORAGE	210 MASTER PASSAGE
011 TBD	211 MASTER W/C
	212 MASTER BEDRM
	213 SITTING RM
	214 ALEXANDRA'S BEDRM
	215 ALEXANDRA'S BATH
	216 MAN CAVE (ATTIC)
101 FOYER	EX-1 OPEN TERRACE
101a COATS ONE	EX-2 COVERED TERR
101b COATS TWO	EX-3 PORTE COCHERE
102 MAIN GALLERY	EX-4 FRONT PORCH
103 GREAT ROOM	EX-5 REAR PORCH
104 LIBRARY	GA-1 2-CAR GARAGE
105 POWDER ROOM	GA-2 1-CAR GARAGE
106 DINING ROOM	ST-1 STAIR FOYER
107 BUTLER'S PANTRY	ST-2 STAIR BSMNT
108 PANTRY	ST-3 STAIR MUD RM
109 KITCHEN	ST-4 STAIR HOMEWORK
110 BREAKFAST	ST-5 STAIR GARAGE
111 MUD ROOM	ST-6 STAIR ATTIC
112 BACK HALL	
113 GUEST BATH	
114 GUEST RM ONE	
115 POOL POWDER RM	

17	3/29/16	1 2x24 # MOSAIC: P/N # MATERIAL, NICHE ALL SLAB
16	3/24/16	SHOWER WAS 1x1 MARMARA BL.
15	3/18/16	SPEC'D 6x6 INSERTS
14	3/14/16	CHANGE ROOM FLOOR TILING
13	1/19/16	SINK SIZES
12	12/18/15	UPDATE LIGHT, MIRROR CHANGE
11	1/18/15	REVISION MATCH SET, NO CHANGE
10	1/14/15	MAT'L SPELLING, ADD MOSAIC THK
9	10/23/15	1" MOSAIC WAS 3/8". REMOVED TILE WALL BASE, ADDED TILE WAINSCOT TO WALLS
8	10/2/15	ADDED SLAB THICKNESS
7	10/1/15	ADDE SHOWER NICHE, SLAB MAT'L
6	10/6/15	SHOWER FIXTURES, VANITY
5	8/31/15	ADDED SELECTED TRIMS, VANITY
4	7/27/15	ADDED STONE SHLEVEESA SHOWER
3	7/2/15	LINEN, VANITY, CONTROLS, MIRROR
2	7/3/15	ADDED TILE, PLATFORM OUT
1	6/27/15	FIRST ISSUED
No.	Date	Revision Description

**DIMENSIONING NOTE:**  
ALL DIMENSIONS SHOWN ARE TO FINISHED SURFACES.  
MAKE ADJUSTMENTS FOR RAW STUDS OR SUBFLOORS.  
SET DOORS & SWITCHES FOR WIDE TRIM. SEE TRIM SCHEDULE.

**FIXTURE NOTES:**  
ITEMS MAY NOT HAVE BEEN SELECTED AT TIME OF DRAWING.  
CONFIRM REQUIREMENTS WITH SPEC SHEETS AS PURCHASED.  
ALL TOILET FEEDS TO BE LOCATED ON THE WALL.  
DO NOT USE PX TUBING FOR VISIBLE TOILET FEEDS.  
AVOID CONFLICTS WITH VENT STACKS & SCONCES & MED. CABS.  
CHECK FOR SPECIAL HEIGHTS DUE TO TILE WORK ON WALLS.  
EXHAUST FANS AND LIGHTS TO BE ON SEPARATE SWITCHES.  
-PLEASE ADVISE DESIGNER IF CONDITIONS ARE NOT AS EXPECTED.

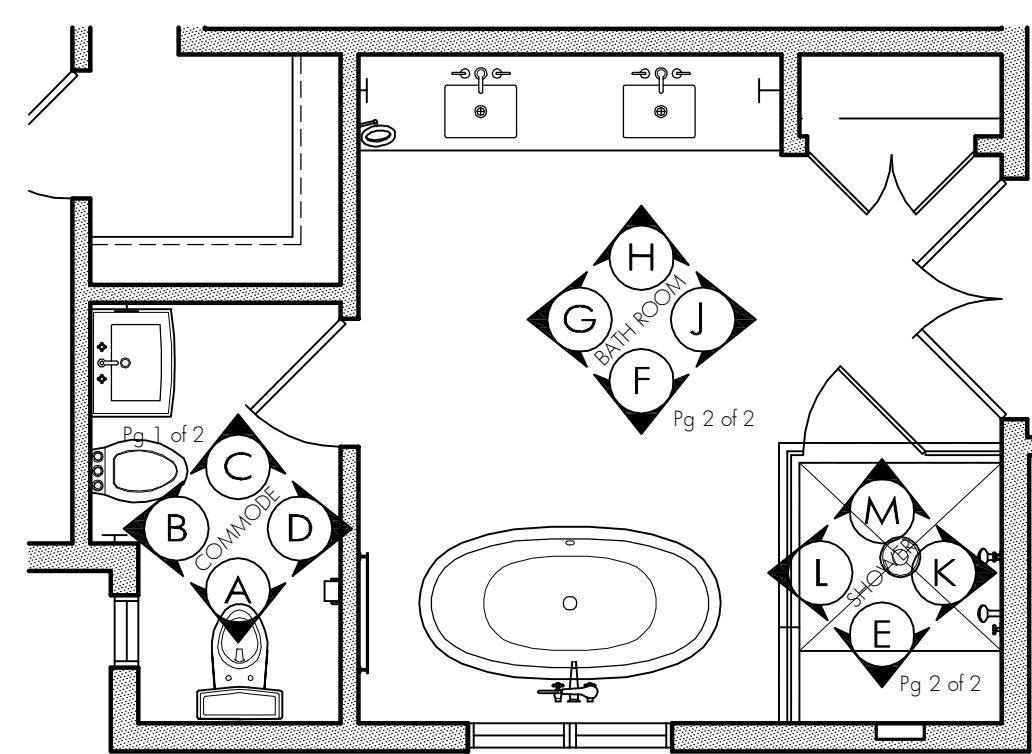
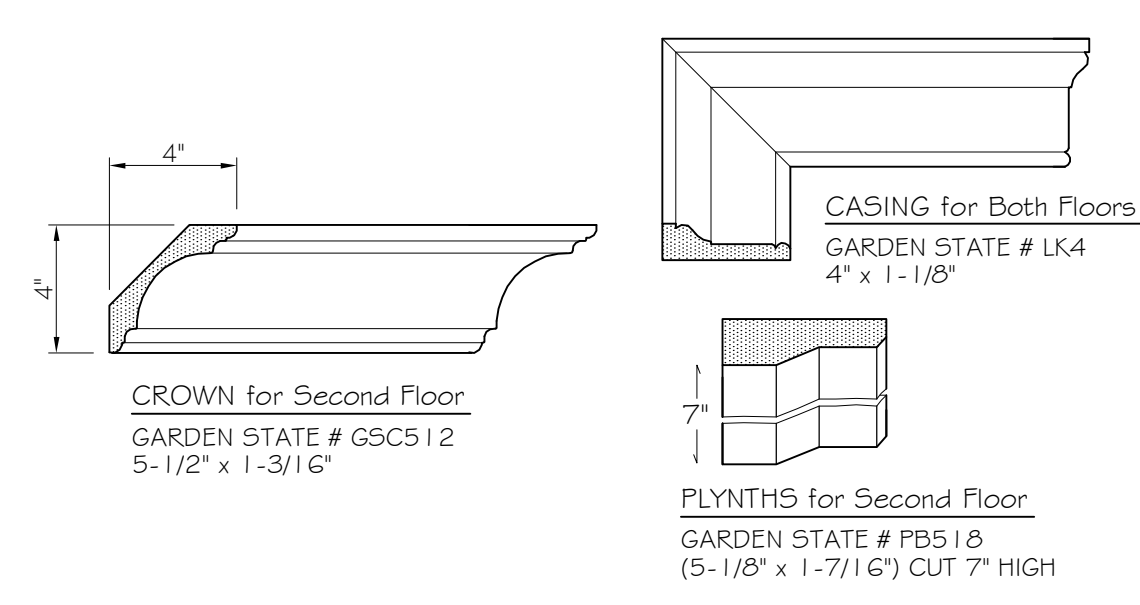

**4 ELEVATION KEY**  
1/4"=1'-0" ~ M.COMMODE 209 # M.BATH 208

**PRELIMINARY**

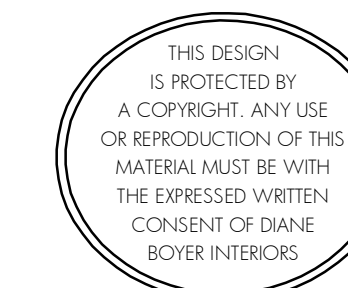

THIS DRAWING IS FOR DESIGN PURPOSES ONLY  
CONTRACTORS MUST VISIT JOB SITE AND VERIFY ALL EXISTING CONDITIONS  
© BASE DRAWINGS FOR CONSULTANT USE PROVIDED BY VIRGONA & VIRGONA ARCHITECTS

**Diane Boyer Interiors**  
271 Grove Avenue  
Verona, New Jersey 07044  
Phone: (973) 857-5900 Fax: (973) 857-5915

**PROJECT**  
CLIENT RESIDENCE  
ANYWHERE, NEW JERSEY

**TITLE**  
ROOM DETAILS  
MASTER BATH 208 &  
MASTER COMMODOE 209  
PAGE TWO OF TWO

Dwg. By:	JDP	Drawing Number	Version
Scale:	AS NOTED	EL-209	SEVENTEEN